

SURFACE WATER LEGEND:	
PROPOSED STORM MANHOLE	MH
PROPOSED RIGID HDPE STORM PIPE	Prop. dia. Pipe ID
PROPOSED GULLY	
PROPOSED HYDROBRAKE MANHOLE	MH
PROPOSED BYPASS SEPARATOR	NSBP
PROPOSED FILTER DRAIN	Filter Drain
PROPOSED RAINWATER HARVEST UNIT	

Data Campus Equipment Legend:	
D1	Data Building 01
D2	Data Building 02
D3	Data Building 03
D4	Data Building 04
D5	Data Building 05
D6	Data Building 06
D7	Ancillary Equipment Compound (DER)
D7(a)	Fire Water Tank
D7(b)	Fire Water Pump House
D7(c)	Storage Building
D7(d)	Diesel Generator
D7(e)	Data Building Water Treatment Unit
D8	Air Insulated Switchgear (AIS) Compound
D9	33kV IPP Building
D10(a)	Fuel Cell Tower 01
D10(b)	Fuel Cell Tower 02
D10(c)	Fuel Cell Tower 03
D10(d)	Fuel Cell Tower 04
D10(e)	Fuel Cell Tower 05
D10(f)	Fuel Cell Tower 06
D11(a)	Carbon Dioxide Process Building (Fuel Cells)
D11(b)	Carbon Dioxide Storage Tanks (Fuel Cells)
D12(a)	Chilled Water Pump House (Fuel Cells)
D12(b)	Chilled Water Tank (Fuel Cells)
D12(c)	Chilled Water Tank (Fuel Cells)
D12(d)	Ancillary Water Tank (Fuel Cells)
D13	Data Campus Facility Entrance Security Building
D14	Above Ground Gas Installation (AGI)
D15	IPP Building & AIS Compound (Fuel Cells)
D16	220kV IPP GIS Building
D17	IPP Building and AIS Compound (Solar Farm)
D18	Battery & MVPS Compound, IPP Building & AIS Compound
D19	Ancillary Equipment Compound (DC Facility)
D19(a)	Fire Water Tank (Data Buildings)
D19(b)	Fire Water Pump House (Data Buildings)
D19(c)	Water Treatment Unit (Data Buildings)
D20	Water Treatment Unit Serving D16, D17 & D18
D21	Combined Fire Water Retention and Attenuation Pond
D22	Habitat Pond

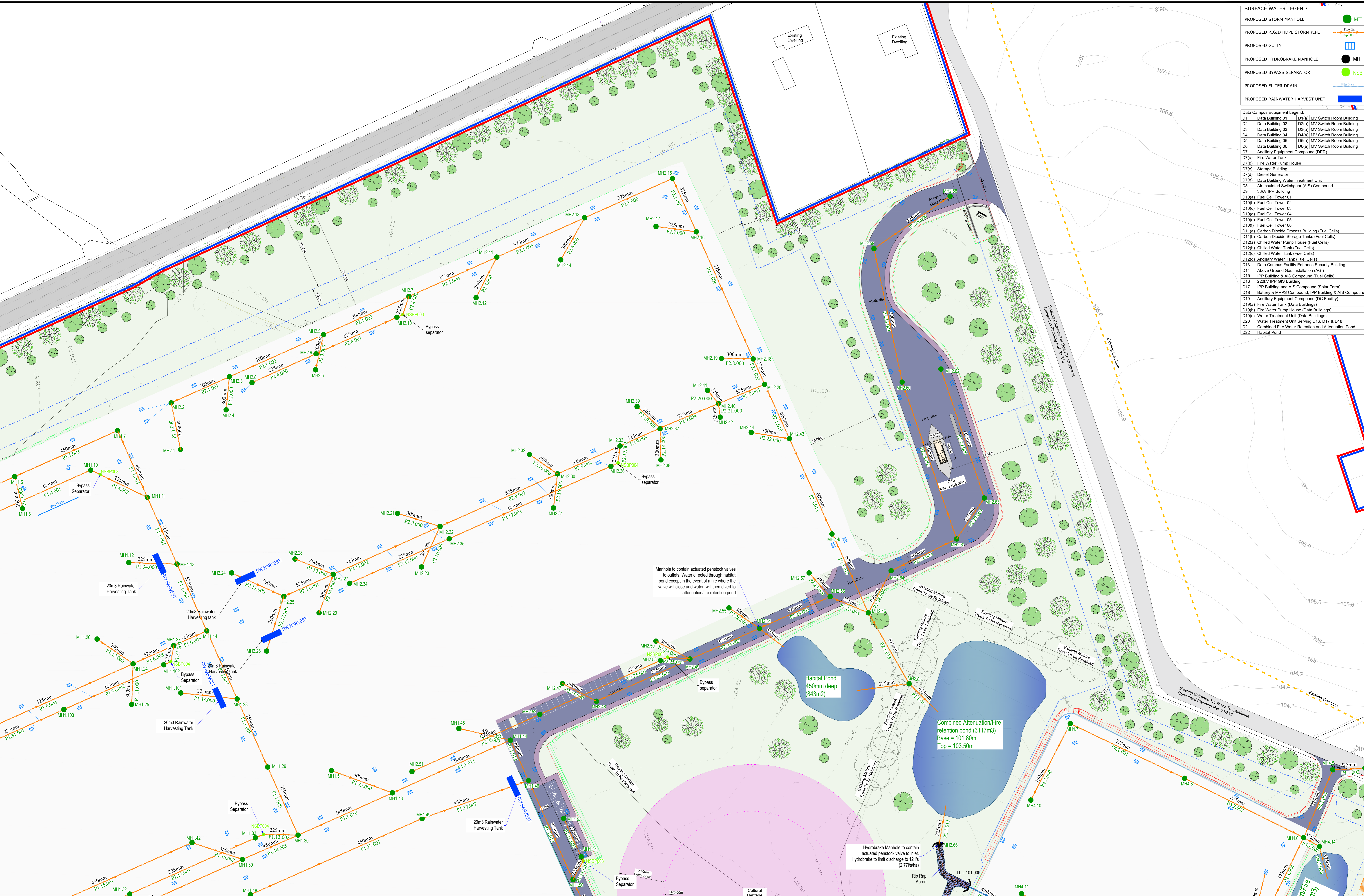

NOTES:
1 FIGURED DIMENSIONS ONLY TO BE TAKEN FROM THIS DRAWING
2 THIS DRAWING TO BE READ IN CONJUNCTION WITH ALL OTHER RELEVANT DRAWINGS AND SPECIFICATIONS

Rev.	Modifications	By	Date
P01	PLANNING	SK	July 25
P02	FURTHER INFORMATION	SK	Mar 26
P03	PLANNING S182	SK	June 26

LEGEND:	
OWNERSHIP BOUNDARY	POST & RAIL FENCE
CUT AREA	FILL AREA
COMPENSATORY WOODLAND	GOLDEN PLOVER HABITAT
FOOTPATHS SECURITY FENCE	CABLE ROUTE

LEGEND (SOLAR):	
4.5m SECURITY FENCE OFFSET	10m BUFFER ZONE (One Side)
5m WIDE GRAVEL ROAD	5m BUFFER ZONE (One Side)
20m BUFFER ZONE (10m Each Side)	10m BUFFER ZONE (5m Each Side)

LEGEND (WEATHER STATION):	
MEDIUM VOLTAGE POWER STATION (MVPS)	SOLAR PANEL ARRAY
COMPENSATORY WOODLAND	GOLDEN PLOVER HABITAT

LEGEND (HORIZONTAL DIRECTIONAL):	
DRILLING	CABLE ROUTE

HALSTON
Email: info@halston.ie
Tel: 094 9010111

IHUB BUILDING WESTPORT ROAD CASTLEBAR CO. MAYO. F23 K16Z

Client	RED ADMIRAL DC LTD	Drawn	SK	Checked	WD	Approved	CS
Project	ADMIRAL	Date	Feb 2025	Scale	1:500	Sheet	1 of 5
Title	PROPOSED SURFACE WATER DRAINAGE LAYOUT	Job No.	SEP-0374	Rev	P02	Sheet Size	A0
Stage	PLANNING	Dwg. No.	CLDC-HAL-DC-XX-PL-1040				